

# SIAMP 49 Dual Flushing Valve

## Fault Finding Guide

### Troubleshooting: Dual Flushing Valve Passing Water



- 1 - Push Button inc Execution
- 2 - Overflow Tube
- 3 - Adjustable Stirrup
- 4 - Valve Gasket
- 5 - Strainer
- 6 - Strainer Seal

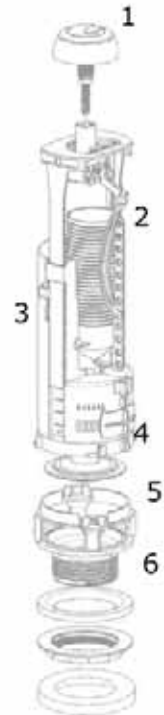

**Note :** Before carrying out the following procedures please check:

1. The water is not escaping through the Overflow Tube (2) if so please see ['Inlet Valve Not Shutting Off'](#)
2. Check the settings of the valve to ensure they are correct and not causing the valve not to seal. *(Fig 1.1)*

It is possible that foreign bodies could get under the Valve Gasket and prevent it from creating a watertight seal. To resolve this please complete the following:

1. Turn off the water supply
2. The Valve Assembly is connected to the Strainer on a bayonet fitment to remove rotate the Valve Assembly Anti-Clockwise away from the Strainer (5).
3. Remove the Valve Assembly from the cistern.
4. Clean the Valve Gasket (4) using clean water only. **DO NOT USE ANY CLEANING AGENTS.** *(Fig 1.2)*
5. Clean the seal area of the strainer using clean water only. **DO NOT USE ANY CLEANING AGENTS.**
6. Once all debris has been successfully removed from both the Valve Gasket (4) and the Strainer (5). Replace the Valve Assembly back in the Strainer by reversing the removal process.

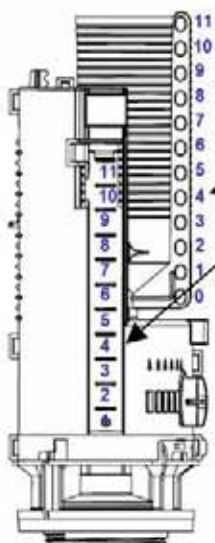

Please ensure the settings on the Overflow Tube (2) and the Adjustable Stirrup (3) are set at the same number.

*Fig 1.1*



*Fig 1.2*

If the problem still persists spare parts may be purchased, if this is the case then these can be obtained on 0161 205 1200 quoting your Purchase Order Number.

**PLEASE NOTE: Parts may be chargeable.**